



DENALI Plow Mount MA11144 CanAm Outlander/Renegade

Thank you for purchasing our DENALI plow mount. You now own a premium custom plow mount to allow you to use your plow with your ATV. Please note the following instructions and heed all warnings.

- Your ATV and/or plow system can cause death or injury, please use caution and common sense when operating your unit.
- Read your Plow Operator Manual, your Winch Operator Manual, and all warning labels before operating your ATV.
- Operate your ATV at a walking speed with the blade installed. Do not exceed 5 mph (8 km/h), even with the blade up.
- Do not operate the ATV on slopes greater than 10 degrees with the plow installed.
- Always lower the plow to the down position before leaving your ATV unattended.

SEVERE INJURY OR DEATH MAY RESULT IF YOU ARE NEGLIGENT

Please verify that all hardware and parts are included in your package

Kit Contents:

Item Number	Description	Quantity
1	Main Mounting Plate	1
2	Rear Buckle	1
3	M8 – 1.25 x 25mm Carriage Bolt	4
4	M8 – 1.25 Serrated Flange Nut	6
5	M8 – 1.25 x 30mm Hex Bolt	2
6	M8 Flat Washer	2

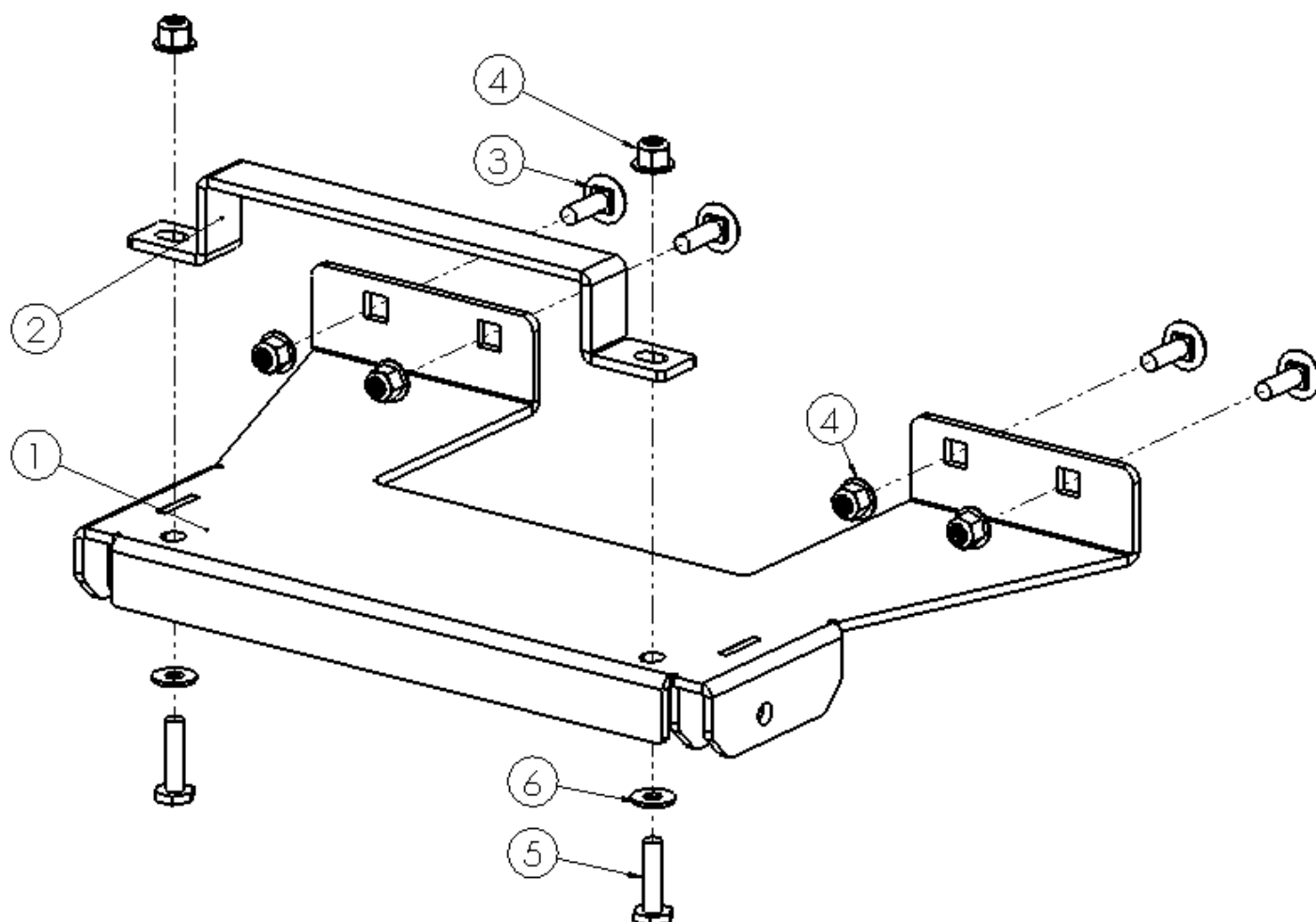

Outlander Plow Mount Assembly:

1. Remove the main plastic underbody skid plate
2. Identify the plastic material outlined in Figure 2 and cut along the red line using a razor blade or hack saw.

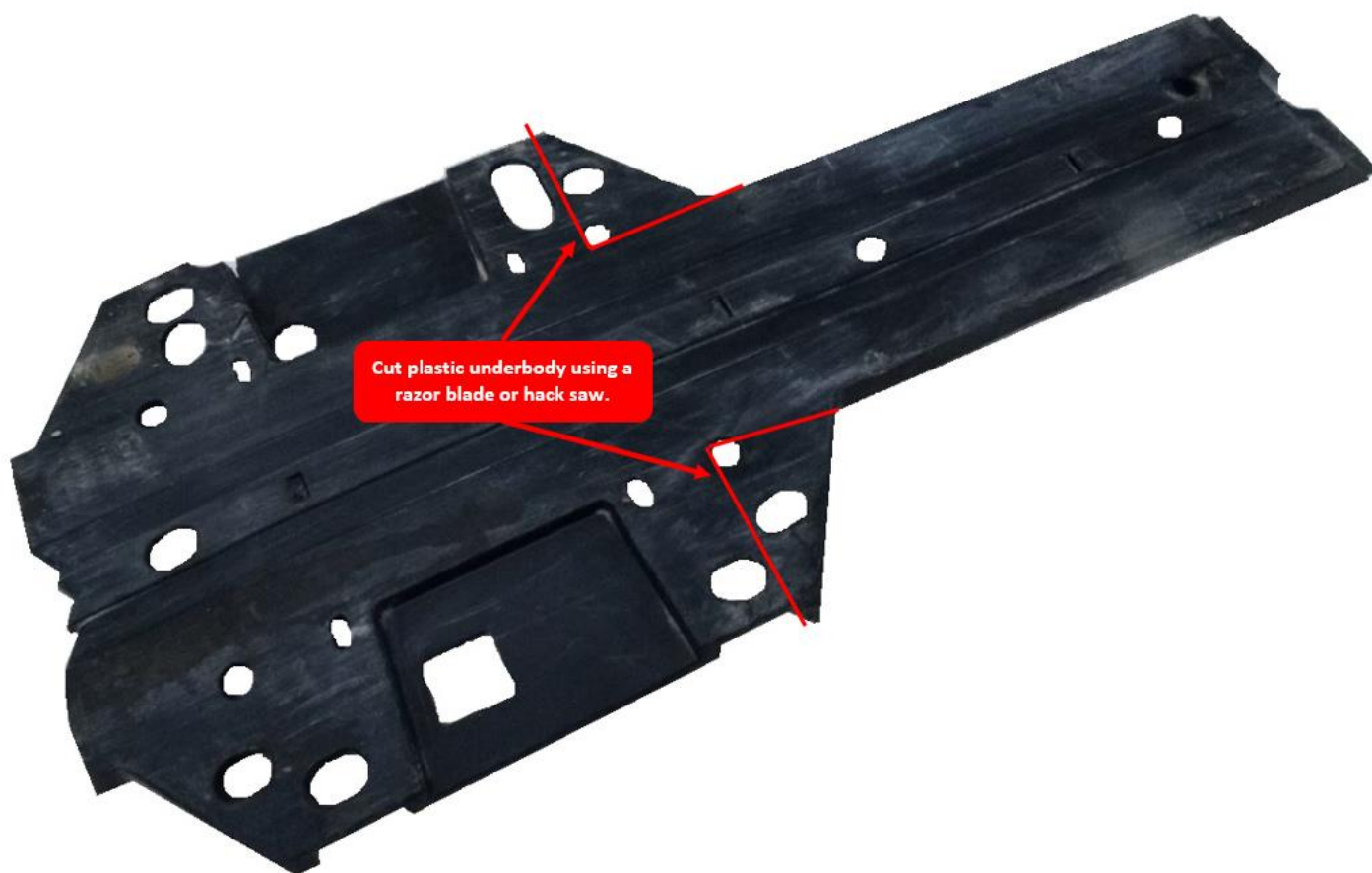

Figure 2

3. Using a 1 1/4" Hole saw drill a hole approximately 1" inbound from the edge of the oval slot in the plastic underbody. The 1 1/4" hole should be drilled approximately at the center of the oval slot as shown in Figure 3.



Figure 3

4. Skip to Step 6

Renegade Plow Mount Assembly:

5. The DENALI center mounted plow system requires access to the chassis of the Renegade. This is achieved in one of two ways.
 - a. Remove the aluminum skid plate and leave it off after installing the plow mount
 - b. Remove the aluminum skid plate and trim off the front portion as shown in Figure 4

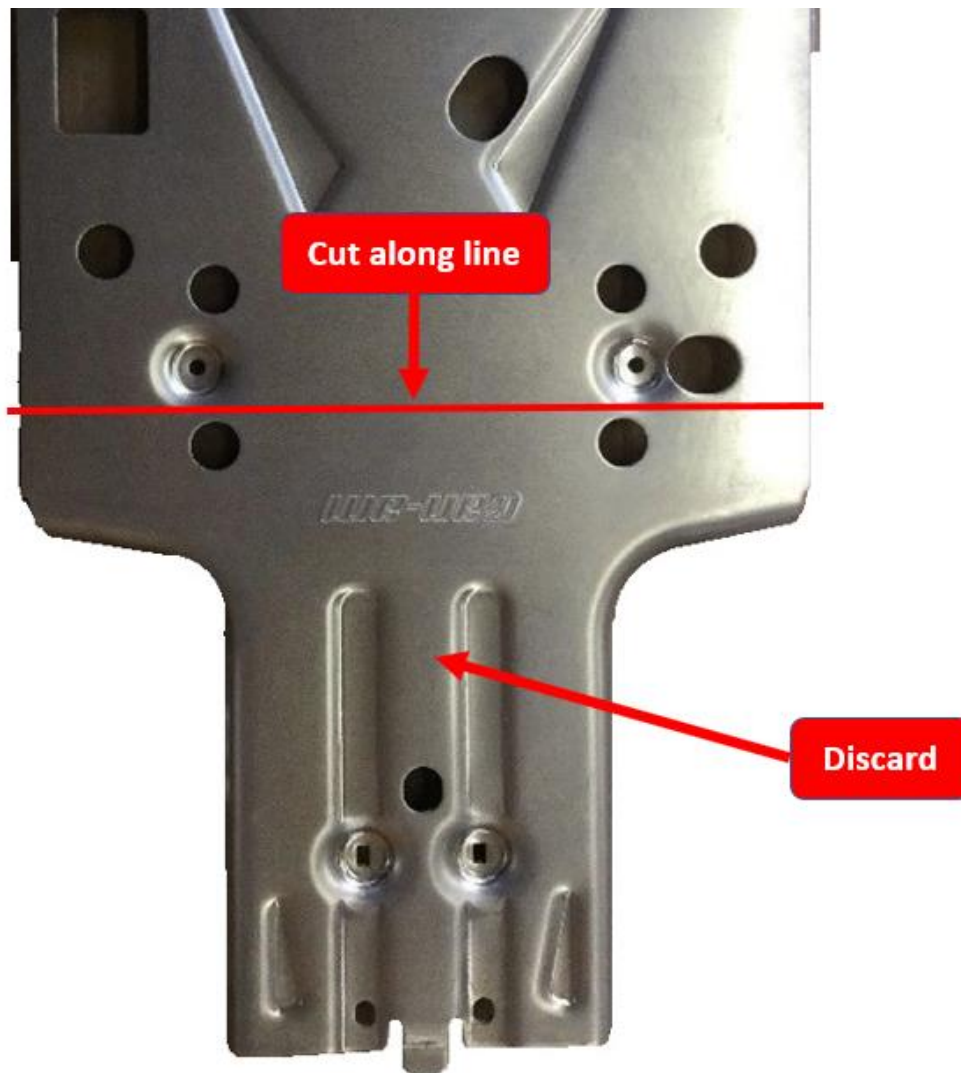

Figure 4

6. Attach the MA11144 plow mount with the Rear Flange facing upward as shown in Figure 1 and Figure 5. The Rear Flange will press against the square tube cross members that are nearest the front of the vehicle.



Figure 5

7. Use the included M8 Carriage Bolts and Nuts to secure the Rear Flanges through the square tube cross member. Remove factory hardware if necessary.
8. Lift the MA11144 mount to the bottom of the vehicle chassis and lay the Rear Buckle over top of the chassis so that the bolt holes align with the plow mount. Insert the remaining M8 Hex Bolts from the bottom up through the Rear Buckle and secure with the included nuts. Tighten all hardware



Figure 6

9. Install the DENALI ATV Pushtubes to the MA11144 plow mount using the quick release clips included with your plow system.